

4W MOBILE CB TRANSCEIVER

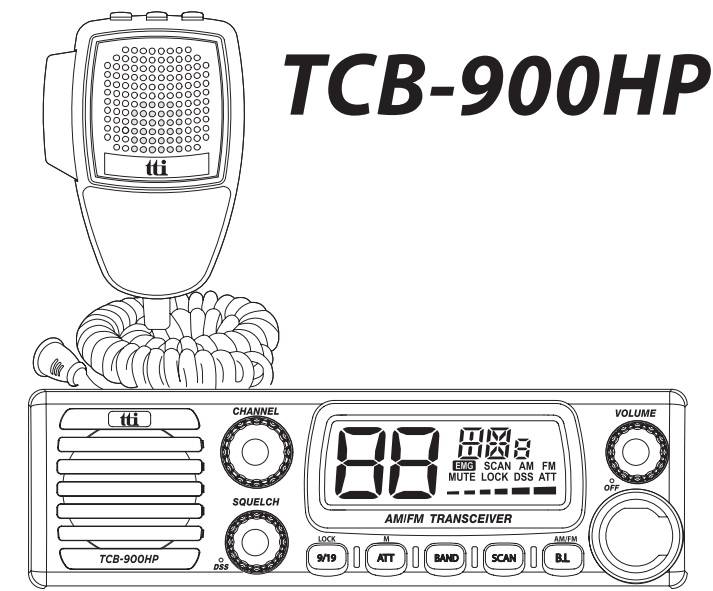

INSTRUCTION MANUAL



www.ttikorea.co.kr

P/N 820-C900-H00

Our Thanks to You

Thank you for purchasing a TTI CB TRANSCEIVER radio. Properly used this TTI product will give you many years of reliable service.

All our products are built to offer excellent value by combining advanced features, great design and manufacturing quality.

To ensure you are familiar with the operation and features of your radio, and in order to obtain the best performance, please read this manual carefully before operation.

1. Supplied Accessories

TCB-900HP is supplied with a full range of accessories to help you get started and virtually benefit from all the features straight away.

- TCB-900HP transceiver 1unit
- Microphone with cord 1unit
- Power cable 1pce
- Radio mounting bracket 1pce
- Radio mounting thumb screw with rubber washer 2pcs
- Mounting screw & washer(for transceiver bracket) 3pcs
- Mounting screw & washer(for microphone bracket) 3pcs
- Microphone mounting bracket 1pce

2. Installation – Transceiver

1) Put the mounting bracket on the proper location where you are going to install. Drill holes and fix mounting bracket on the location.

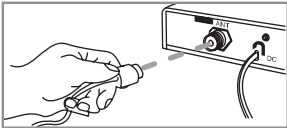

2) Connect the antenna cable plug to the standard receptacle on the transceiver, which is marked “ANT”.

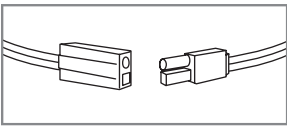

3) Connect the power cable directly to the vehicle battery or fuse box of the car. Be careful to make sure of the polarity of the battery first and connect the cable. (Red: Positive Pole(+), Black: Negative Pole(-). The same colours are shown on the battery and in the fuse box of the car.)

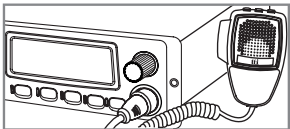

4) Connect the power cable to the transceiver cable.

5) Mount the microphone bracket on one side of the transceiver or near it using two screws included. Connect the microphone to the transceiver’s microphone receptacle.

Now you are ready to operate the transceiver.

3. Installation – Antenna

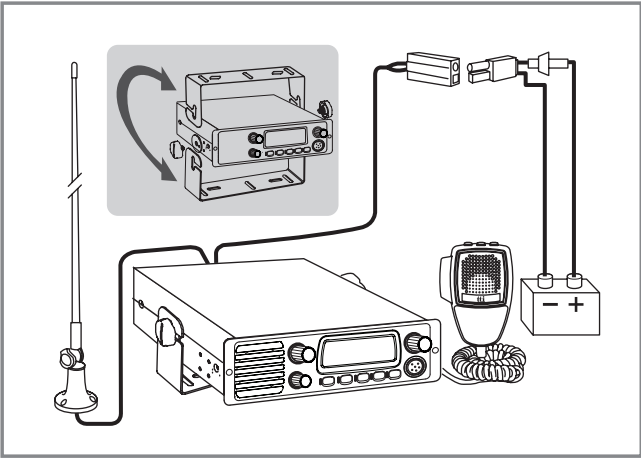

It is very important to select a good quality high efficiency 27MHz antenna. A poor quality antenna or one not designed for the 27MHz band will give very poor performance and could cause damage to the transceiver.

- Place the antenna as high as possible.
- The longer antenna is, normally the better is the performance of the transceiver.
- Try to mount the antenna in the centre of the surface that you select.
- Make sure that you have a solid metal-to-metal ground connection.

Warning : Never try the operation of your transceiver before connecting a proper antenna in order not to cause any damage.

6. Microphone

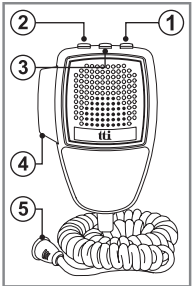

- Up Button : Button to change channels upward.
- Down Button : Button to change channels downward.
- Mute and Lock Button  
Short press to make the transceiver speaker mute.  
Long press to activate/deactivate keypad lock of both microphone and transceiver.
- PTT Button : While pressing this button, you can transmit
- 6 Pin Microphone Connector : Connect this to the microphone jack on the front panel of the transceiver.

7. Trouble Shooting

If you experience problems with your TCB-900HP transceiver, first check connection of power supply, microphone and antenna. If this does not solve the problem, reset your transceiver as follows.

- Switch off the transceiver.
- Press and hold EMG(9/19) button, switch on the transceiver.
- Wait for a while until reset display disappears.

All the memories are erased by this transceiver reset and the parameters return to the initial factory setting. In case of further difficulty, please consult your dealer or visit our website.

8. Safety Requirement

This power cable is for 12/24V DC only.

4. Transceiver Controls and Functions

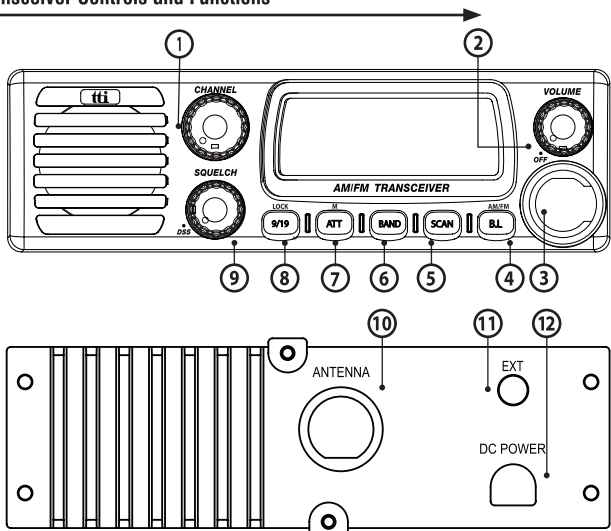

- Channel Selector  
Turn right or left to select channel that you like to use.
- Volume & Power On/Off Knob  
To switch on the transceiver, turn this knob clockwise. The more you turn this knob clockwise, the audio sound grows.
- Microphone Jack  
Insert the microphone into this jack. Use the guide for easy connection.
- Backlighting and AM/FM  
Short press to change Seven Backlighting colours.  
Long press to switch between AM and FM modes.
- Scan Button  
Press this button to start scanning upward to catch any channels that are occupied by others. To activate/deactivate the channel scan, press the Scan button briefly. Turn the channel selector counter-clockwise during scanning in order to change the scanning direction.

6) Band Selection  
Press this Band button, the LCD display offers you the band information. Turn the channel knob to change the band. The band chart for each area is as follows.

Setting	Display	Settings
EC	EC	Europe 40ch. FM 4W
E	E	Spain 40ch. AM/FM 4W
F	F	France 40ch. FM 4W, 40ch AM 4W
PL	PL	Poland 40ch. AM/FM 4W (Polish Frequencies : 5KHz)
UK	UK	UK 40ch. FM 4W (British Frequencies)
UE(EU/UK)	UE	UK 40ch. FM 4W (British Frequencies) + CEPT 40ch. FM 4W(EC)
I	I	Italy 40ch. AM/FM 4W
I2	I2	Italy 34ch. AM/FM 4W
D	d	Germany 80ch. FM 4W, 40ch. AM 4W
D2	d2	Germany 40ch. FM 4W, 12ch. AM 4W
EU	EU	Europe 40ch. AM/FM 4W

7) Attenuation and Menu Button  
Short press to activate/deactivate about 10dB attenuation of the receiving signal strength. This is normally used in the area where the signal strength is too strong.  
Long press to access menu mode. Use the channel selector to change the setting.

Display	Functions	Settings
Pr H	Microphone Gain	High ( H ) and Low ( L )
bP ON	Beep Tone	On ( ON ) and Off ( OFF )
Lo OFF	Time-out Timer	30,60,90,120,150,180,210,240,270,300 Seconds and Off ( OFF )
Sc Lo	Scan Receiver Timer	1-99 Seconds and Continue ( L )

5. LCD Display

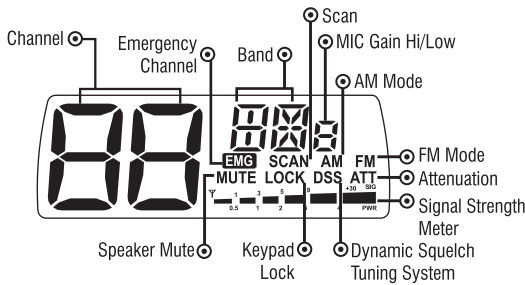

9. Specifications

GENERAL	Channel	40 (See the frequency band chart)
	Frequency Range	26.56 MHz ~ 28 MHz
	Operating mode	F3E (FM), A3E (AM)
	Frequency Control	PLL Synthesizer
	Frequency Tolerance	0.002%
	Operating Temperature Range	-10 to +55 °C
	Microphone	Plug-in Type
	Input Voltage	13.2V DC ± 15%
TRANSMITTER	Size	171 (W) x 51 (H) x 170 (D)
	Weight	1080 grams
	Antenna Connector	SO-239 type
	Power Output	Duty cycle 10% 4 Watts @ 13.2V DC
	Modulation	AM: from 85% to 95% FM: 1.8KHz ± 0.2KHz
	Frequency Response	300Hz to 3000Hz
	Output Impedance	50ohms, Unbalanced
	Harmonic Suppression	Less than -54dBm
RECEIVER	Current Drain	AM Full Mod. 1.6A Max.
	Receiving System	Dual conversion superheterodyne
	IF Frequencies	Double conversion 1st 10.695MHz/2nd 455KHz
	Sensitivity	1.4µV for 10dB(S+N)/N in AM Mode 0.8µV for 20dB SINAD in FM Mode
	Audio Output Power	2.0W @ 8ohm
	Audio Distortion	Less than 8% @ 1KHz
	Image Rejection	More than 60dB
	Adjacent Channel Rejection	More than 60dB
	Conducted Spurious	Less than -57dBm
	Frequency Response	300Hz to 2500Hz
	Built-in Speaker	8ohms, Round
	Squelch	Adjustable; Threshold less than 1µV DSS; Less than 2µV

\* Specification is subject to change without prior notice.

10. Restrictions on the use

Country	Settings				Use restrictions and other comments	
BELGIUM SWITZERLAND	EU	F		EC	40 Ch - 4W FM - Individual licence is required 40 Ch - 4W AM - Individual licence is required	
DENMARK,NORWAY LUXEMBOURG,CZECH				EC	40 Ch - 4W FM - Free use	
FINLAND,PORTUGAL FRANCE,NETHERLANDS	EU	F		EC	40 Ch - 4W FM - Free use 40 Ch - 4W AM - Free use	
GERMANY	D				80 Ch - 4W FM - Individual licence is required	
		EU			40 Ch - 4W AM - Individual licence is required	
					40 Ch - 4W AM - Use ch 4-15 only	
	D2			EC	40 Ch - 4W FM - Free use	
					12 Ch - 4W AM - Individual licence is required	
	fx Allowed: from 26,960 to 27,410 MHz "BAPT 222 ZV 104"					
GREECE	E	EU	F	I	EC	40 Ch - 4W FM - Free use
						40 Ch - 4W AM - Free use
	T/R 20-02					
IRELAND	E	EU	F	I	EC	40 Ch - 4W FM - Free use
						40 Ch - 4W AM - Free use
	S.I. No 436 of 1998. WIRELESS TELEGRAPHY ACT, 1926 (SECTIONS) (EXEMPTION OF CITIZENS' BAND (CB) RADIOS) ORDER, 1998					
ITALY	E	EU	F	I	EC	40 Ch - 4W FM - General authorization is required
						40 Ch - 4W AM - General authorization is required
				I2		34 Ch - 4W FM
						34 Ch - 4W AM(ERP) *AM mode allowed on ch1-23 only
	PNF issued on DM 08.07.02 NOTES 49 A-B-C-D-E-G					
SPAIN	E	EU	F		EC	40 Ch - 4W FM - Individual licence is required
						40 Ch - 4W FM - Individual licence is required
	Art. 57 - Law 11/1998 dated 24th April					
SWEDEN		EU	F		EC	40 Ch - 4W FM - Free use
						40 Ch - 4W AM - Individual licence is required
UK	UK				EC	40 Ch - 4W FM - Free use
		EU				40 Ch - 4W AM - Free use
POLAND	PL	EU			EC	40 Ch - 4W FM / AM - Free use

<< Declaration of Conformity >>

We, TTI Tech Co., Ltd. (B-912, Indeokwon IT Valley, 40 Imi-ro, Uiwang-si, Gyeonggi-do, Korea) declare on our sole responsibility that this equipment complies with the essential requirements of the Radio Equipment Directive (RED) 2014/53/EU, and that any applicable Essential Test Suite measurements have been performed.

Kind of equipment :   MOBILE CB TRANSCEIVER

Type-designation :   TCB-900HP

Version (where applicable) :

This compicance is based on conformity with the following standards, specifications or documents :

EN 62311:2008	
EN 300 433	V2.1.1
EN 301 489-1	V2.2.0
EN 301 489-13	V1.2.1
EN 60950-1:2006+A11:2009	+A1:2010+A12:2011+A2:2013



N. Y. Kim  
Director

Korea, Nov. 30, 2019

Signature